

Inset E
T 3 & 4 S R 13 W
SCALE IN KILOMETERS
SCALE FOR ENLARGEMENTS IN MILES

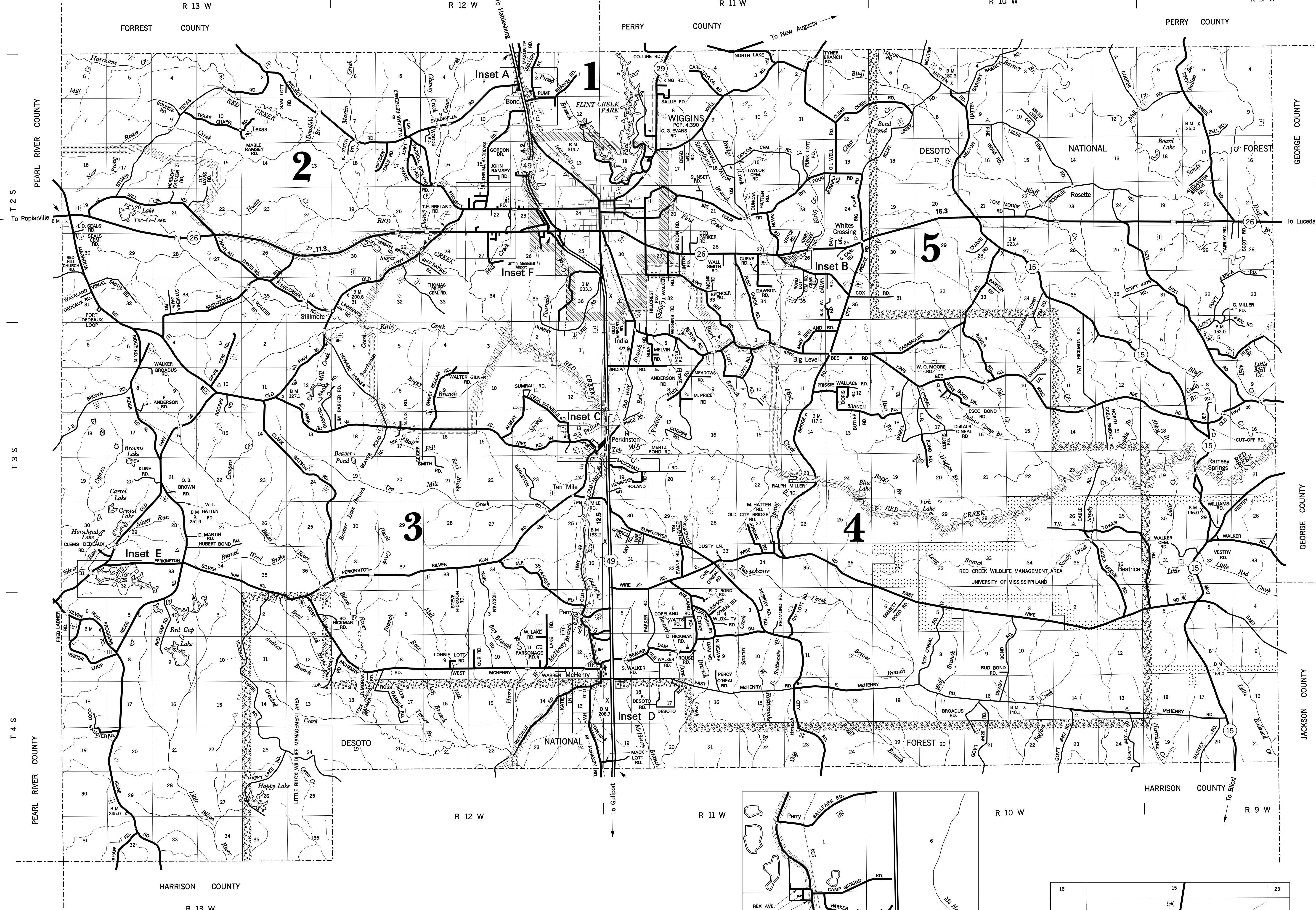

MISSISSIPPI DEPARTMENT OF TRANSPORTATION
COPYRIGHT LICENSE AGREEMENT
With the purchase of this map, the Mississippi Department of Transportation grants you the right to use the copyrighted map as a reference only for personal use.
The map is owned by the Mississippi Department of Transportation and is protected by copyright law. No part of this map may be reproduced, stored in a retrieval system, or transmitted in any form or by any means, electronic, mechanical, photocopying, recording, or by any information storage and retrieval system, without the prior written permission of the Mississippi Department of Transportation.
You have a non-exclusive right to reproduce and distribute the copyrighted map to which, or in part, without modification, provided the Mississippi Department of Transportation copyright is displayed in a prominent visible location on each reproduction.
Any modification of this map which requires the use of the map to be used, copied, or distributed, provided the Mississippi Department of Transportation copyright is displayed in a prominent visible location on each reproduction.
This agreement is governed by the laws of the State of Mississippi, U.S. Federal Law, and U.S. International Treaties.
Contact your state or federal agency for more information on copyright law. Mississippi Department of Transportation, Planning Division, Post Office Box 1050, Jackson, Mississippi 39215-1050

LEGEND

- ROADS AND ROADWAY FEATURES**
 - UNIMPROVED ROAD
 - GRAVEL
 - PAVED ROAD
 - UNDIVIDED HIGHWAY
 - DIVIDED HIGHWAY
 - INTERSTATE SYSTEM
 - CITY STREETS
 - BRIDGE 50 FEET AND OVER
 - DRAWBRIDGE
 - HOVY FREE OR TOLL
 - HIGHWAY GRADE SEPARATION
 - HIGHWAY INTERCHANGE
- ROAD SYSTEM DESIGNATION**
 - INTERSTATE NUMBERED
 - STATE NUMBERED
 - U.S. NUMBERED
- RAILROADS**
 - RAILROAD STATION
 - RAILROAD ABOVE
 - RAILROAD BELOW
- AIRPORTS**
 - MILITARY AIRPORT
 - AIRPORT LIMITED FACILITIES
 - LANDING AREA OR STRIP (INCLUDING PRIVATE AIR FIELDS)
 - AIRPORT COMPLETE FACILITIES
 - AIRWAY LIGHT BEACON
- BOUNDARIES**
 - STATE BOUNDARY
 - COUNTY BOUNDARY
 - BEAT LINE
 - CONGRESSIONAL TOWNSHIP
 - SECTION LINE
 - NATIONAL OR STATE FOREST
 - RESERVATION PARKS ETC.
 - URBAN AREA COMPACT
 - INCORPORATED PLACES
 - UNINCORPORATED DELIMITED AREAS
- NAVIGATION**
 - DOCK, PIER OR LANDING
 - LEVEL OR DIRT
 - LEVEL OR DIRT WITH ROAD
- CITY AND VILLAGE CENTERS**
 - COUNTY SEAT
 - OTHER CITIES AND VILLAGES
- MISCELLANEOUS**
 - TRANSLATION STATION
 - BENCH MARK WITH ELEVATION
 - PUBLIC SERVICE FACILITIES
 - PIPELINE GAS (JO FOR OIL)
 - TRANSMISSION LINE
 - UNDERGROUND TELEPHONE CABLE
 - HIGHWAY GARAGE
 - POST OFFICE
 - POWER PLANT
 - WEIGHT STATION
 - HOSPITAL
 - SEWAGE DISPOSAL PLANT
 - COMMUNITY CENTER OR TOWNHALL
 - NATIONAL PARK GARAGE
 - FIRE STATION
 - PUBLIC LIBRARY
 - SANITARY LAND FILL
 - CORRECTIONAL INSTITUTION
 - POLICE STATION
 - GRAVEL PIT
 - REST AREA
- CONSERVATION AND RECREATION**
 - MOTEL OR LODGE
 - CAMP OR HOTEL
 - HISTORIC OR SCENIC SITE
 - FISH GROUNDS OR RACE COURSE
 - SMALL PARK
 - GOLF COURSE OR COUNTRY CLUB
- INDUSTRIAL**
 - FACTORY OR INDUSTRY
 - SEASONAL INDUSTRY
- CHURCHES AND CEMETERIES**
 - CHURCH
 - CEMETERY
 - CHURCH WITH CEMETERY ADJACENT
- EDUCATION**
 - SCHOOL
- MISCELLANEOUS STRUCTURES**
 - ARMORY
 - FORT/ARMY CAMP

DATA SOURCES
2006 ASCS AERIAL PHOTOS
1987 USGS DLG
1994 MDT FIELD INVENTORY
2010 POPULATION 17,786
2002 BEAT LINES

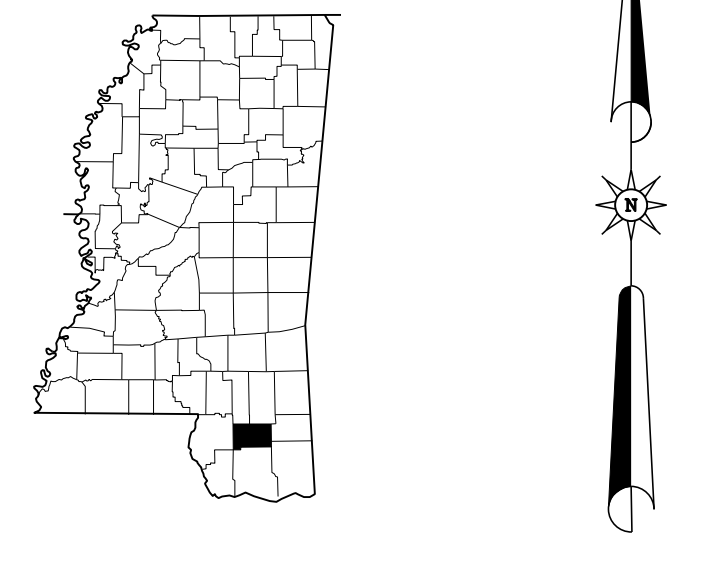

GENERAL HIGHWAY MAP

STONE COUNTY

MISSISSIPPI
© 2007

MISSISSIPPI DEPARTMENT OF TRANSPORTATION
PLANNING DIVISION
IN COOPERATION WITH THE
U.S. DEPARTMENT OF TRANSPORTATION
FEDERAL HIGHWAY ADMINISTRATION
TRANSVERSE MERCATOR PROJECTION,
STATE PLANE COORDINATE SYSTEM 1983

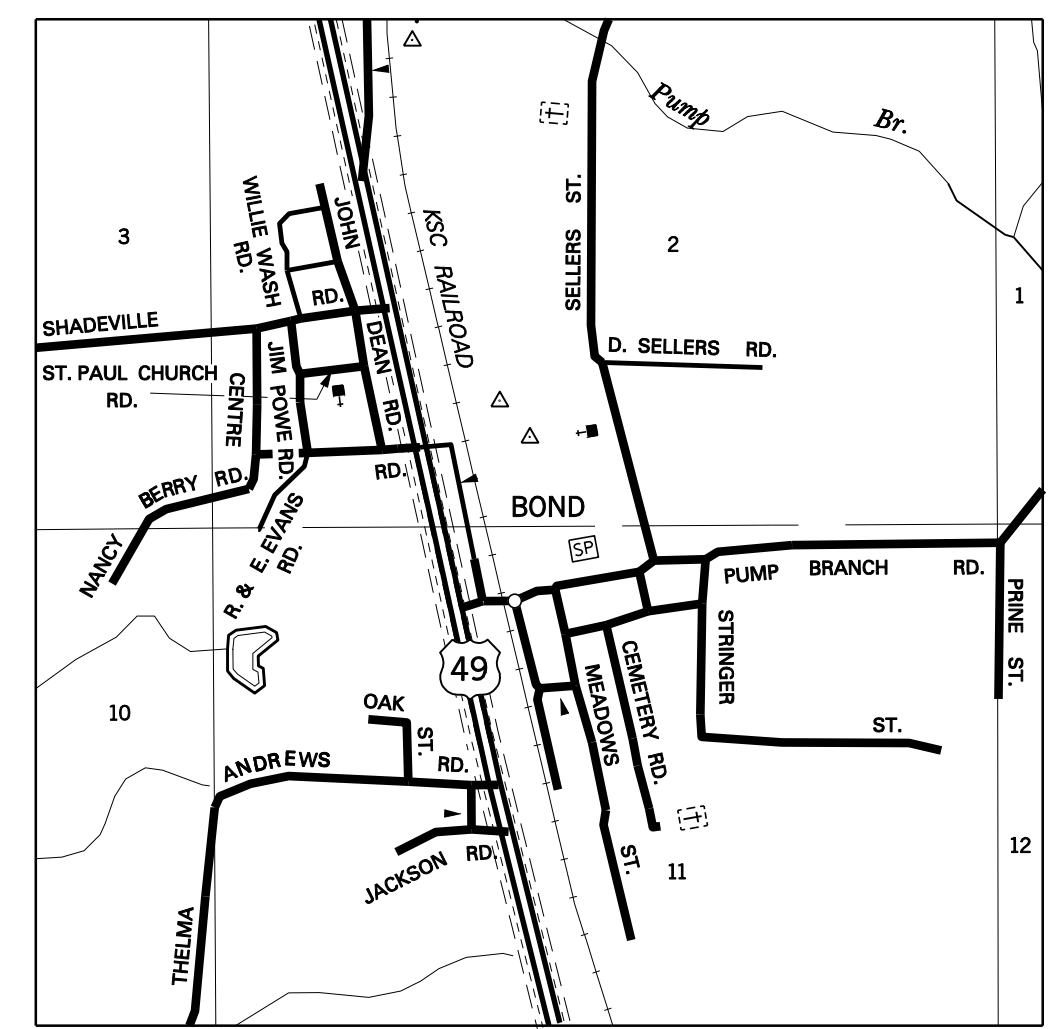
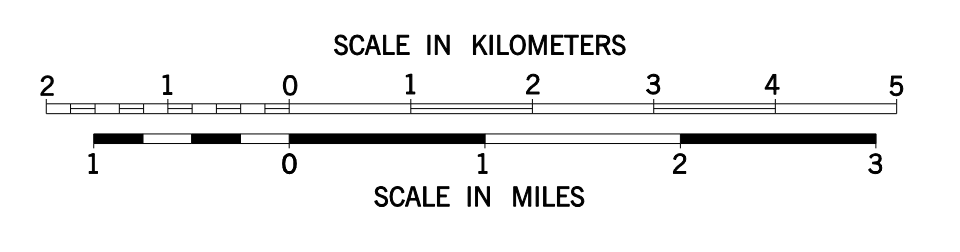

Inset A
T 2 S R 12 W

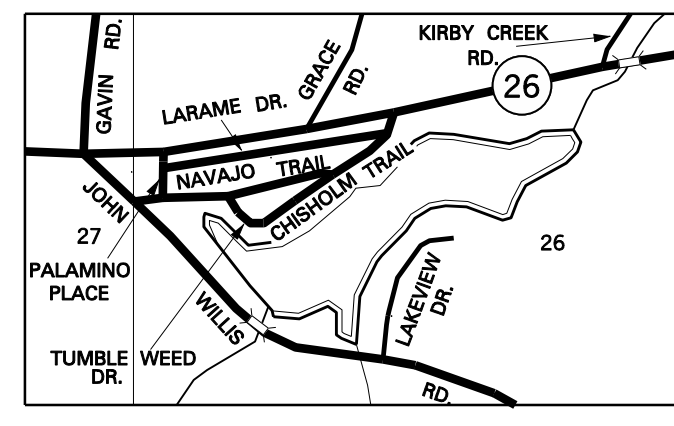

Inset B
T 2 S R 11 W

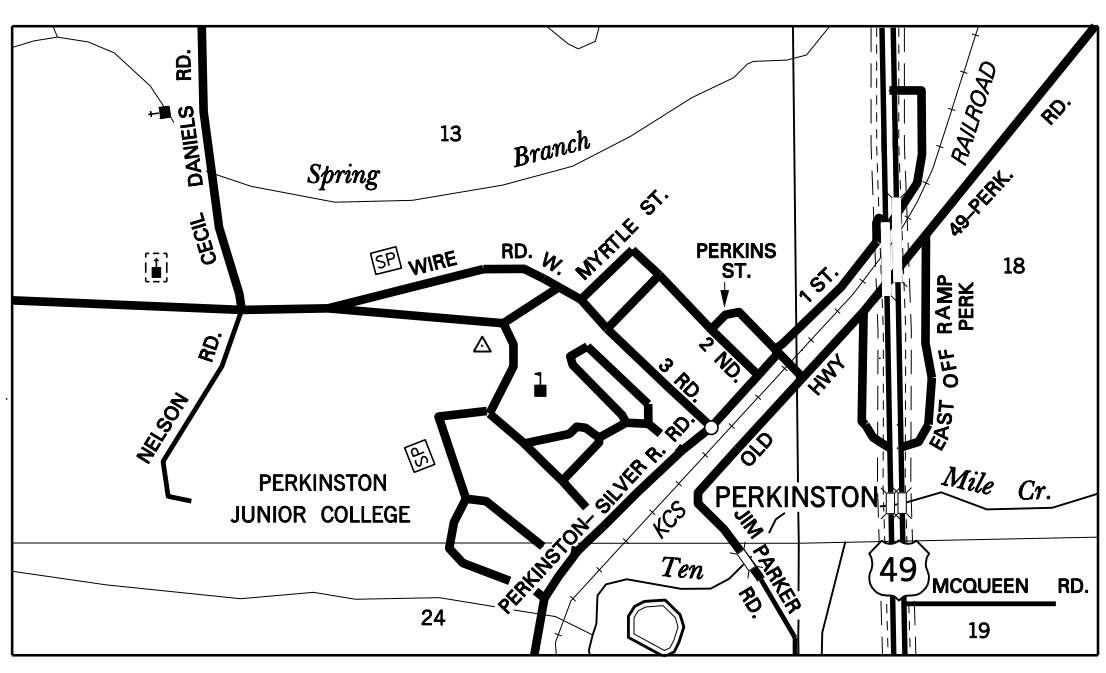

Inset C
T 3 S R 11 W R 12 W

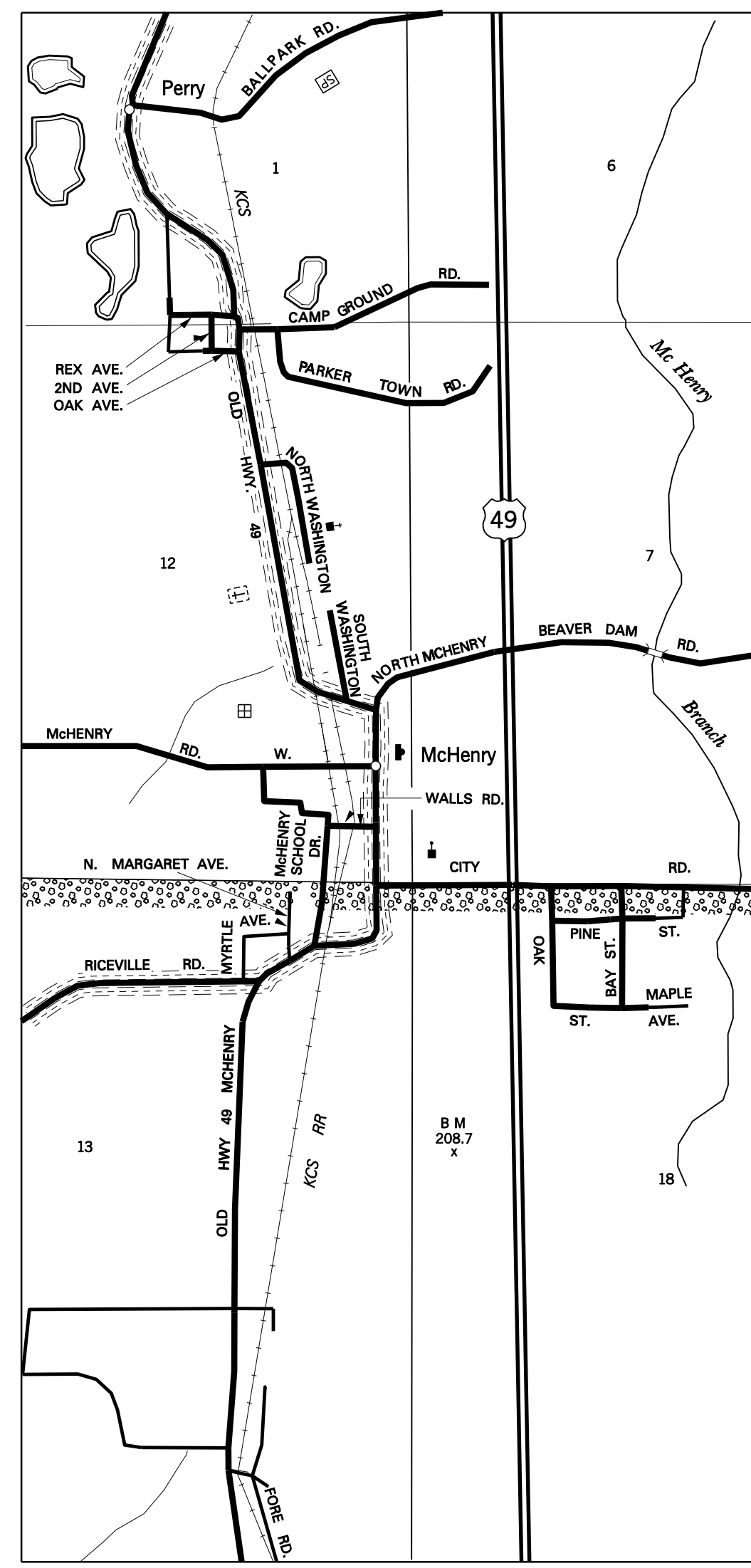

Inset D
T 4 S R 11 W R 12 W

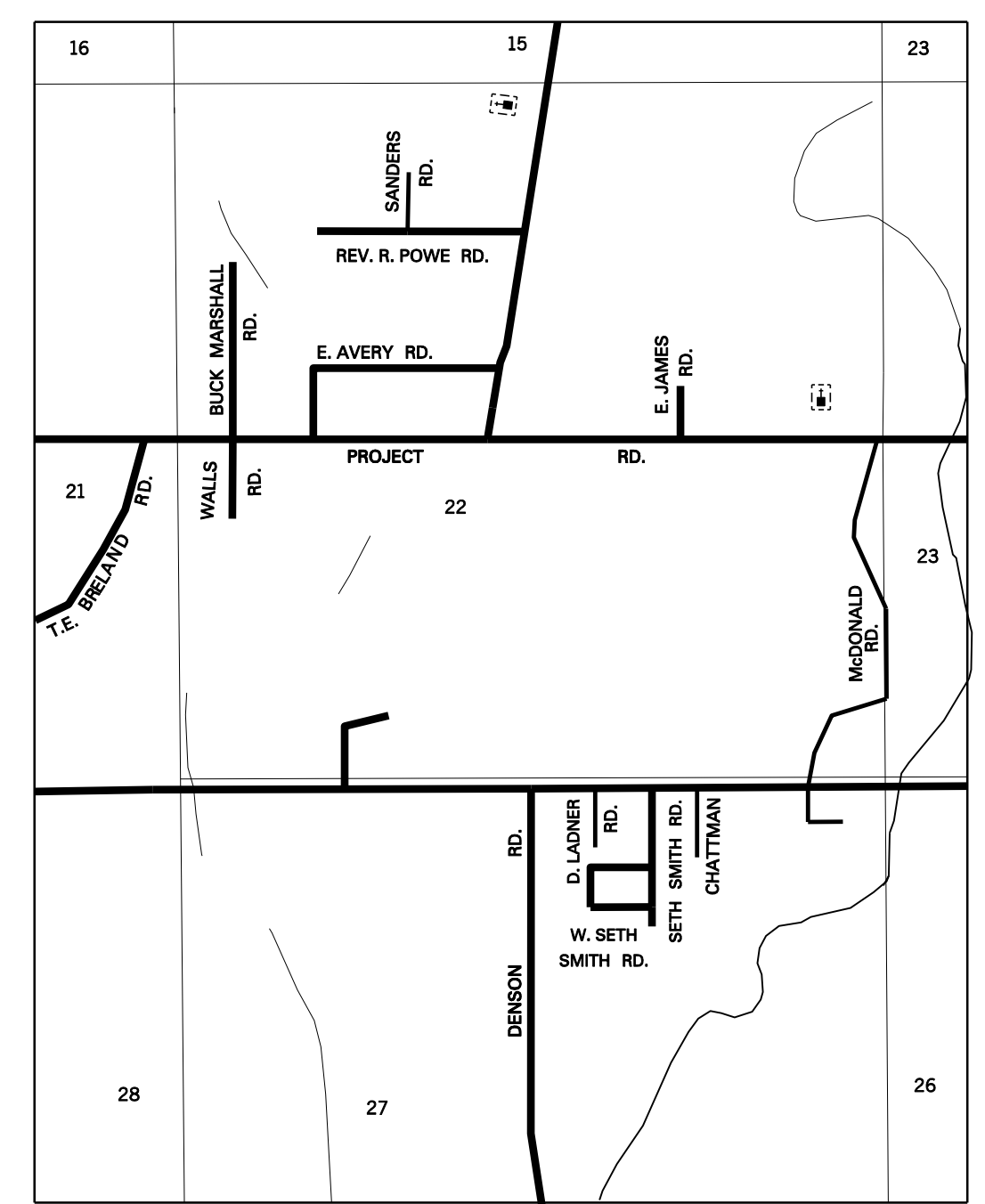

Inset F
T - 2 - S R - 12 - W

